

**ÁREA TÉRREO (CRAS) = 227,10M<sup>2</sup>**  
**ÁREA SUPERIOR (CRAS) = 409,22M<sup>2</sup>**  
**ÁREA TOTAL (CRAS) = 636,32M<sup>2</sup>**

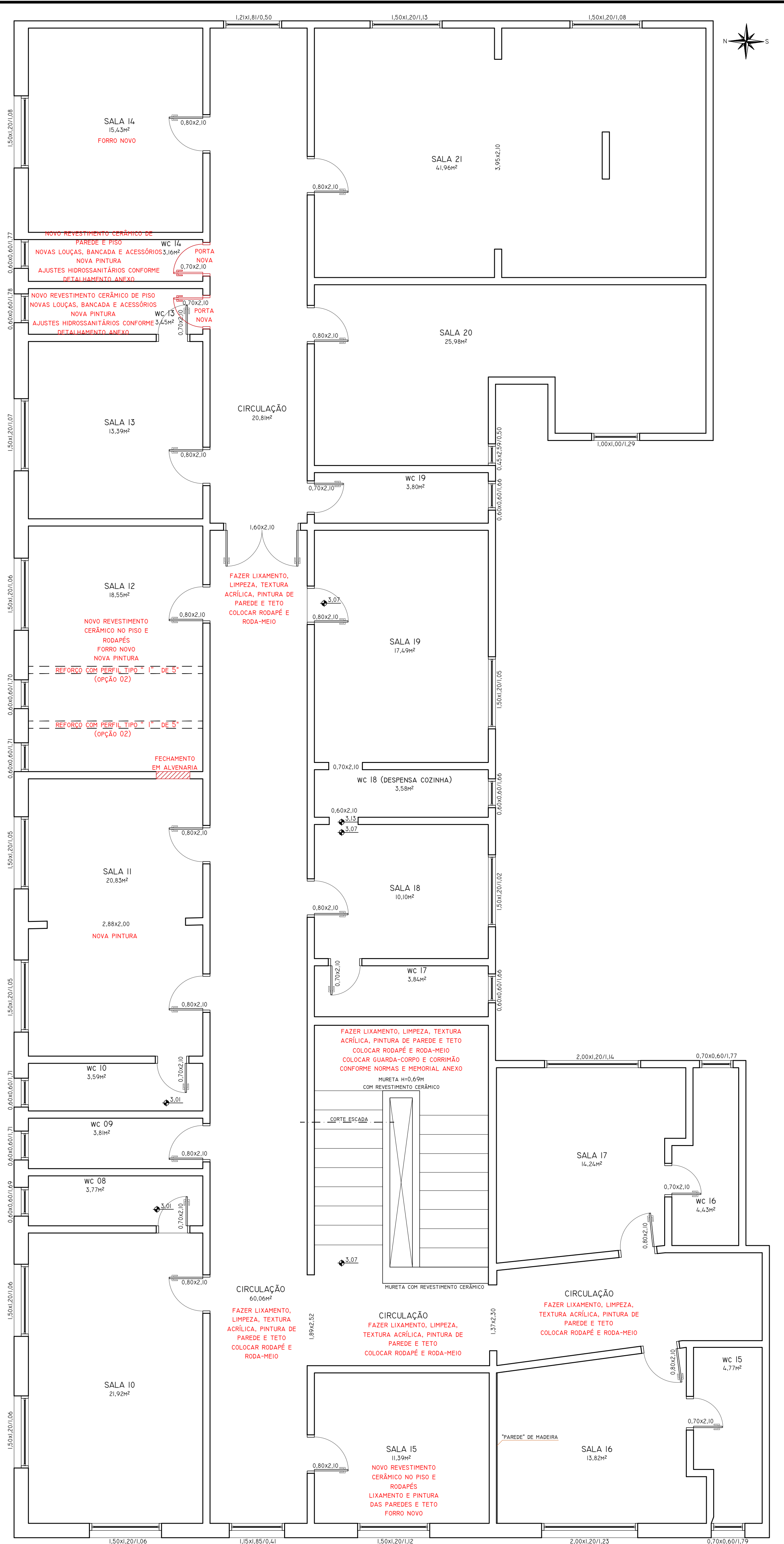

**ÁREA TÉRREO (CRAS) = 227,10M<sup>2</sup>**  
**ÁREA SUPERIOR (CRAS) = 409,22M<sup>2</sup>**  
**ÁREA TOTAL (CRAS) = 636,32M<sup>2</sup>**

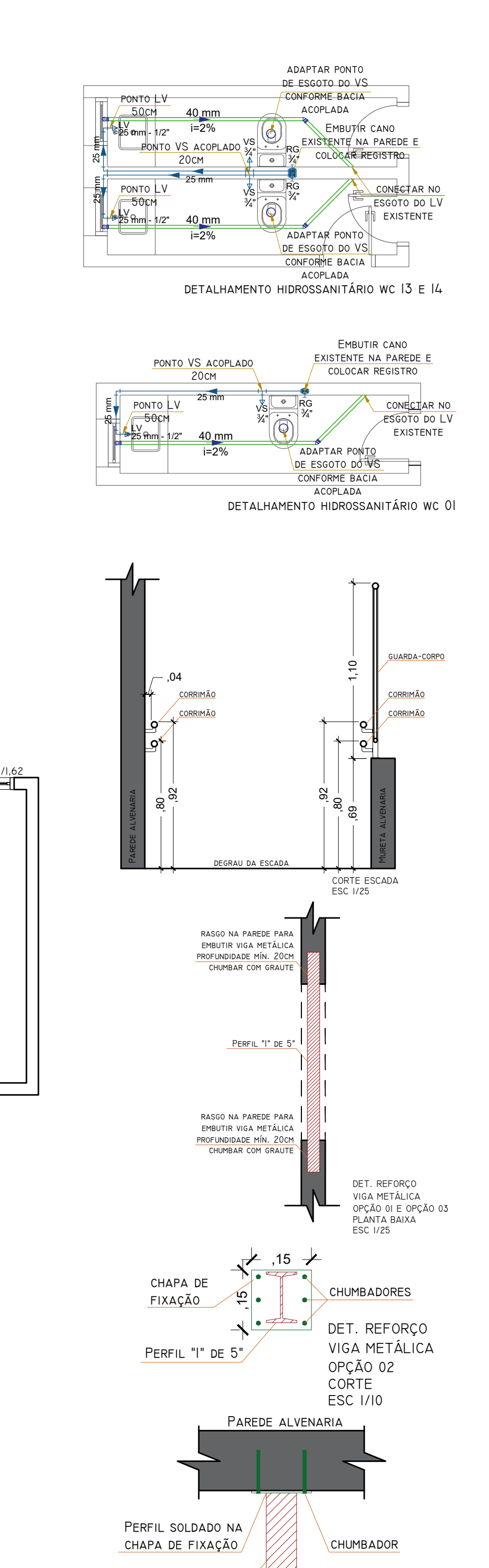
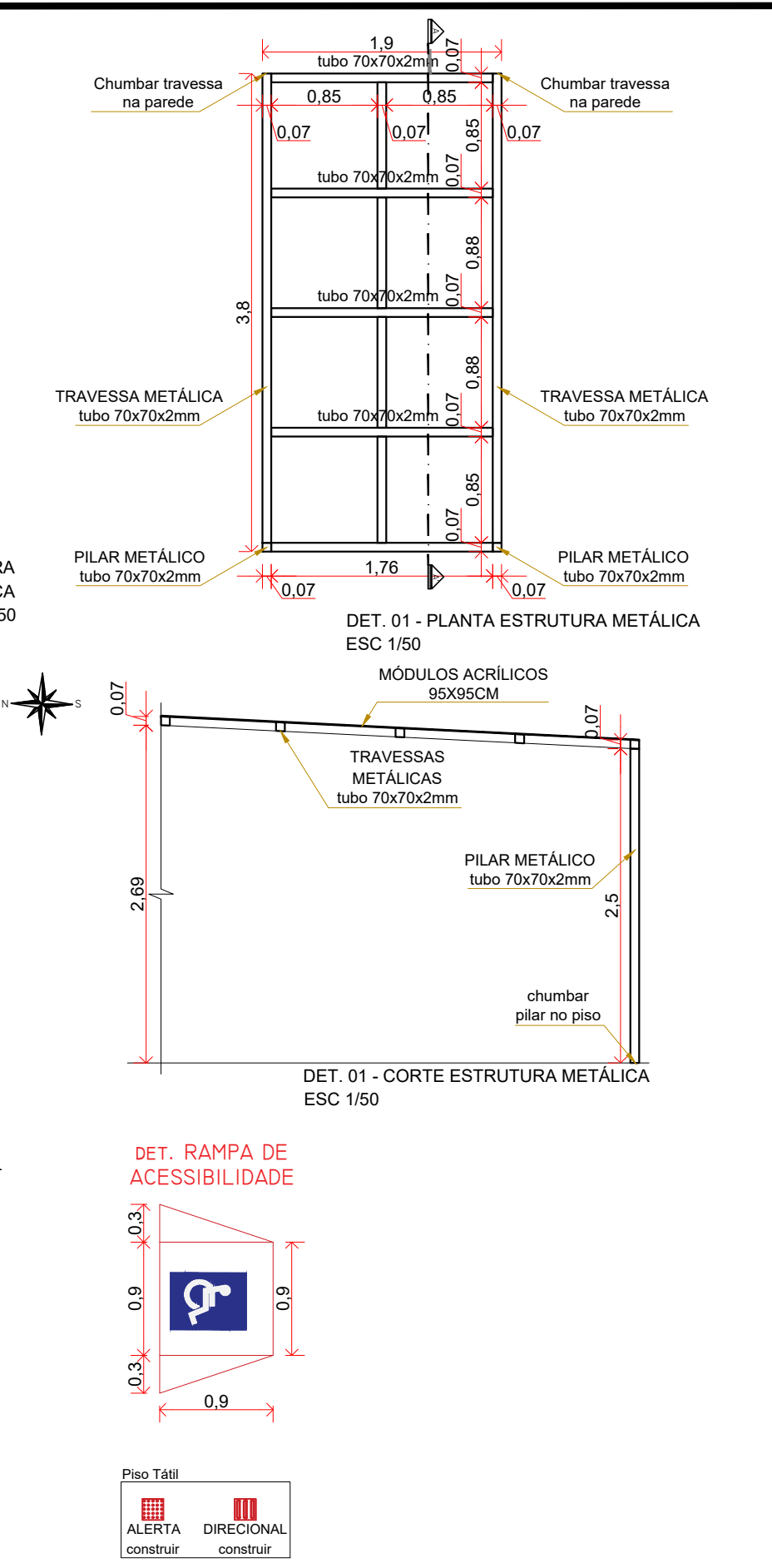
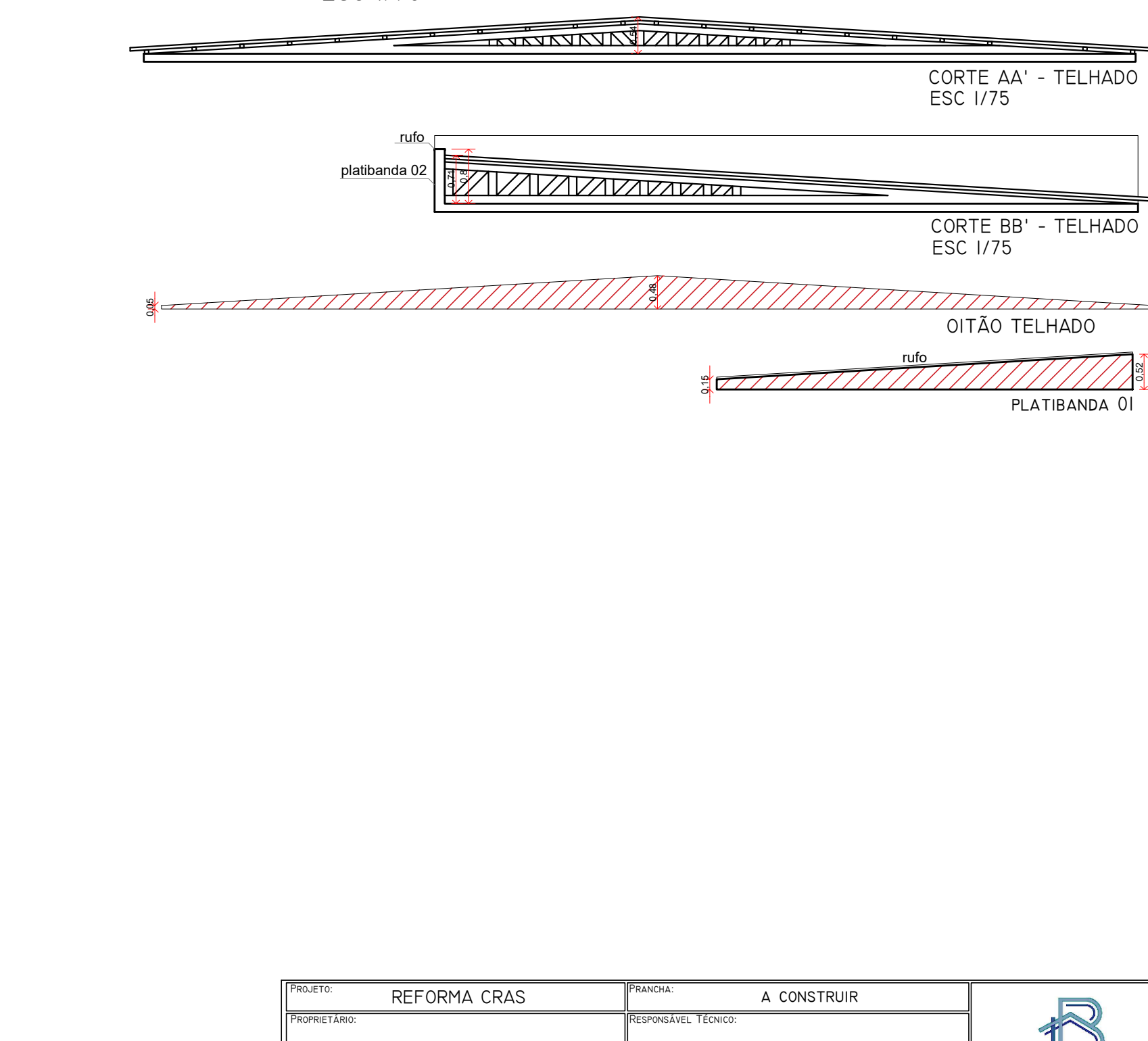
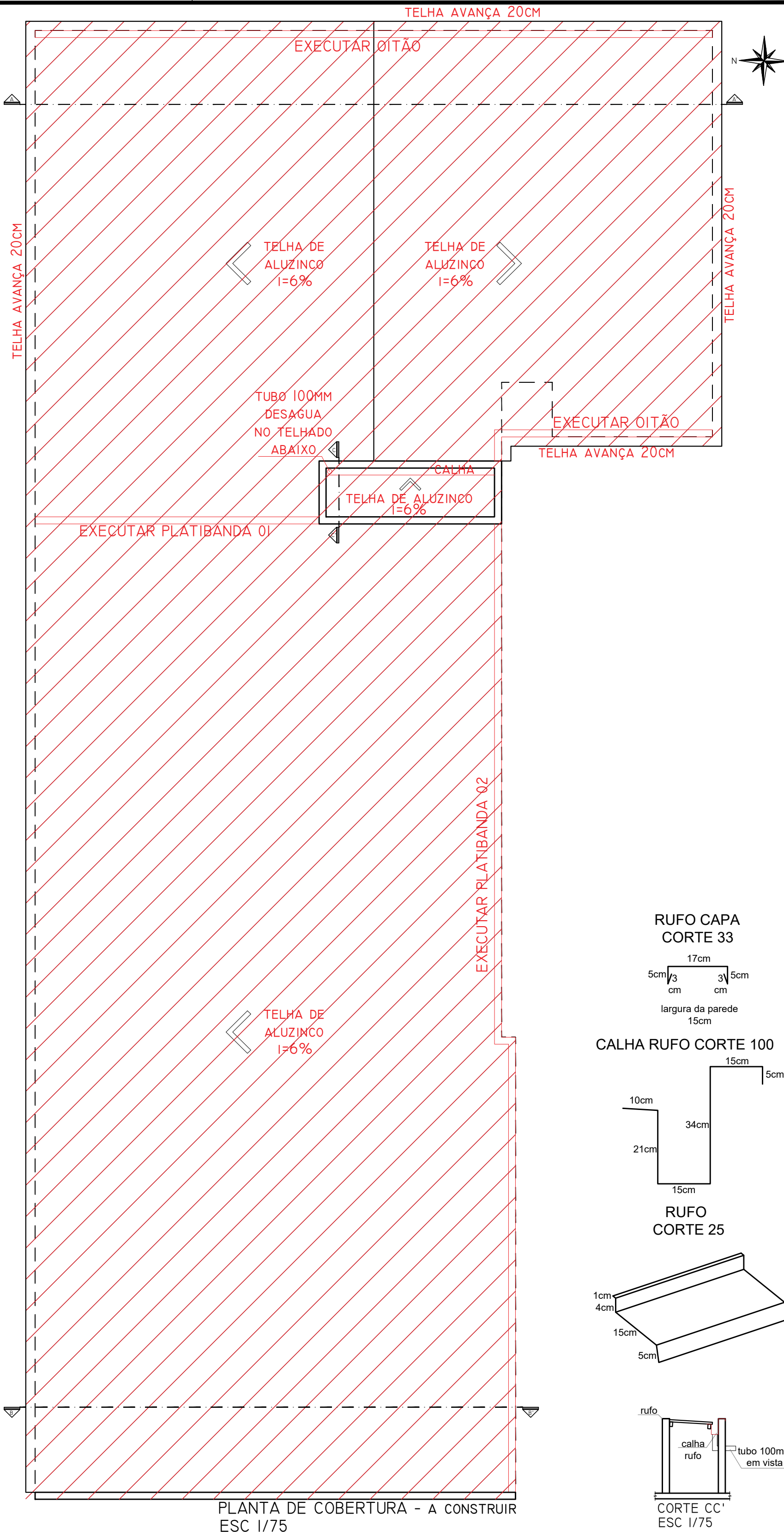

PROJETO: REFORMA CRAS	PROJETA: A CONSTRUIR	
PROPRIETÁRIO: PREFEITURA MUNICIPAL DE INDEPENDÊNCIA	RESPONSÁVEL TÉCNICO: LUANA EMANUELLE BUTZKE	
LOCAL: INDEPENDÊNCIA/RS	ESCALA: INDICADA	DATA: MARÇO/2026
CNPJ 87.612.826/0001-90	ENGENHEIRA CIVIL CREA RS23634.0	(55) 99914-2323
		PRANCHA 02/03