

SARJETA DE CONCRETO - 140,00 metros

Detalhe de Sarjeta de Concreto

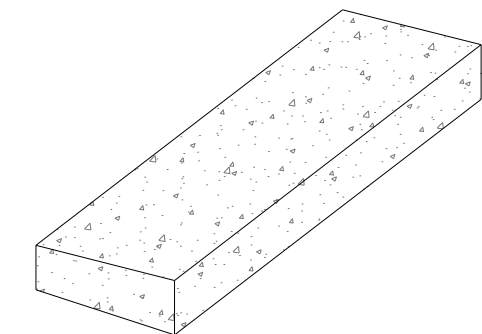

PERSPECTIVA
Sem Escala

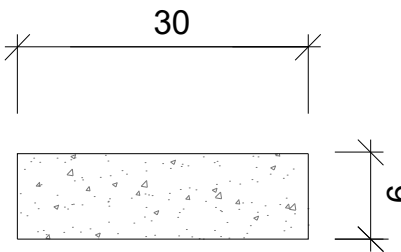

VISTA LATERAL
Sem Escala

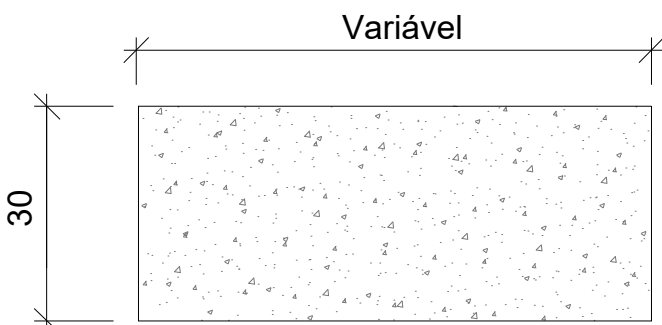

VISTA SUPERIOR
Sem Escala

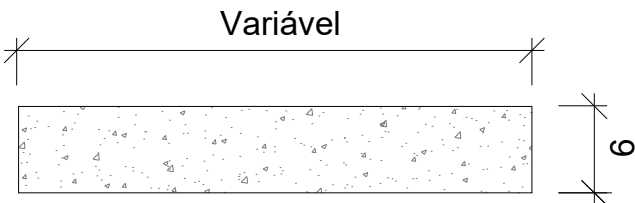

VISTA FRONTAL
Sem Escala

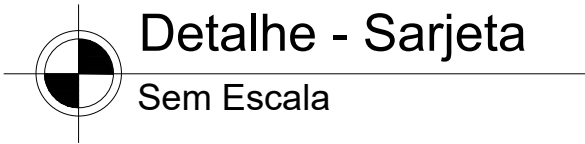

Obra Pavimentação Asfáltica

Local Rua Presidente Vargas
Alecrim - RS

Proprietário Prefeitura Municipal de Alecrim - RS

Engº Civil - CREA/RS 102.506-D
Responsável Técnico

Prefeito Municipal

Tema: PLANTA DE SARJETA DE CONCRETO

Escala: Indicada Data: Julho/2025 Revisão:

prancha
03
04